

Scope of delivery

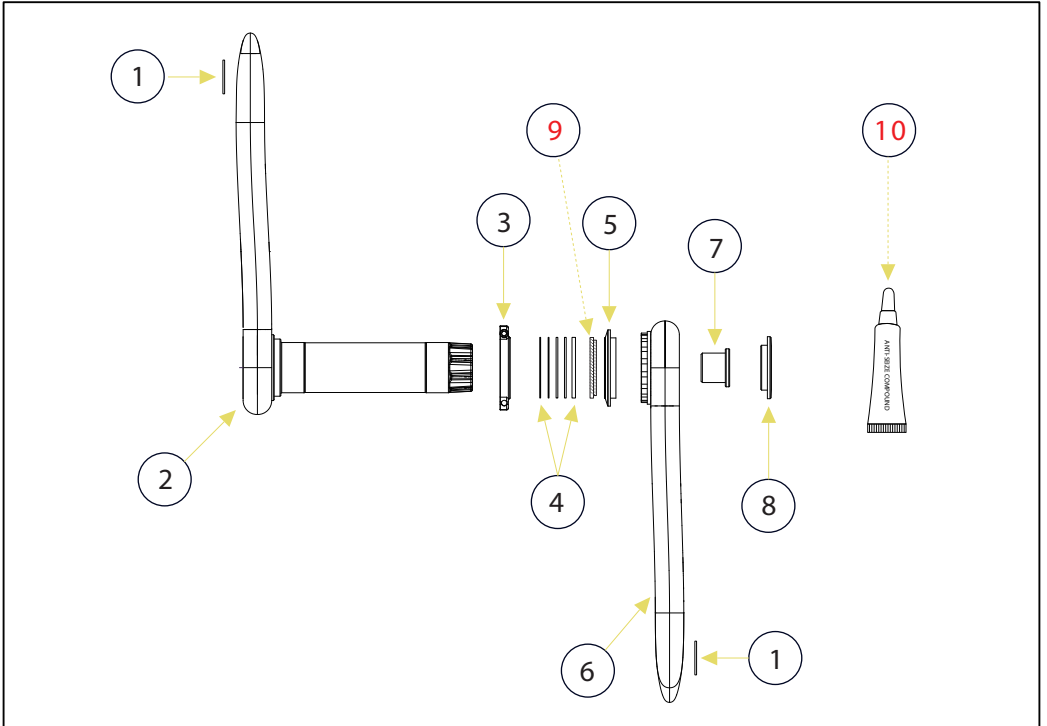

- | | | | |
|---|-------------------------------|---|----------------------|
| 1 | Pedal spacer | 5 | Spider lock ring |
| 2 | Left crankarm(NDS) | 6 | Right crankarm(DS) |
| 3 | Preload ring | 7 | Self-extracting bolt |
| 4 | Spacer(0.5*2 / 1.0*2 / 2.0*1) | 8 | Self-extracting cap |

TI24 ONLY	9	24mm axle spacer
	10	Anti-seize compound

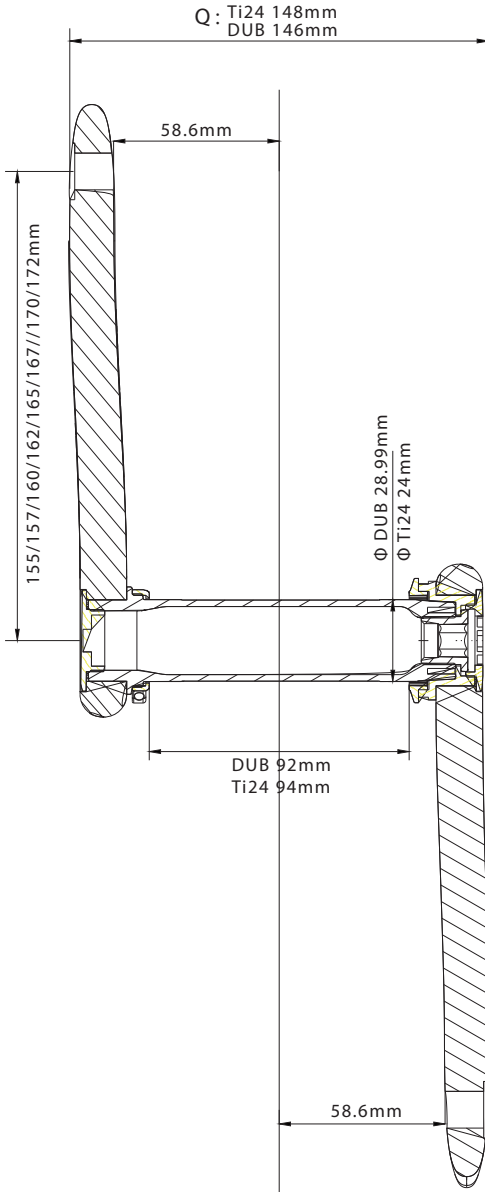

Weight
326g DUB Spindle (165mm) 326g 24Ti Spindle (165mm)
Crankarm lengths
155/157/160/162/165/ 167//170/172mm
Chainline
44.5mm
Q-Factor
Ti24 148mm DUB 146mm
Inner width
117.2mm
Spindle diameter
DUB 28.99mm Ti24 24mm
Overall Bottom bracket width
DUB 92mm Ti24 94mm

Tools Required

Torque Wrench
 10 mm Allen Key / Hex Bit
 ParkTool BBT-22 Bottom Bracket Tool
 Vernier Caliper
 Rubber Mallet
 Anti-seize or Assembly Grease

1. Install Standard or Power Meter Spider

Compatible with Easton-standard spiders, including power meters from XCADEY, SIGEYI, P2M, etc.
 Use ParkTool BBT-22 to tighten the locking to 35–40N·m.
 For 24Ti axles, a specific washer must be installed before tightening (only for 24 mm axles).

2. Measure Total Bottom Bracket Width

Use a vernier caliper to measure the shell width after BB installation.

3. Install Non-Drive Side Crankarm

Apply grease to the spindle area.

For Ti24 axles: Use anti-seize on the threads, and grease on the BB contact surface.

For DUB axles: Apply grease to threads and BB contact surface. Anti-seize is not required.

Note: Interface paste is strictly prohibited for both Ti24 and DUB specifications.

Insert the crankarm and spindle into the bottom bracket.

4. Install Drive-Side Spacers

DUB:

No spacers required if width is between 91–92 mm.

If width <91 mm, spacer = (92 mm – Measured Width) ÷ 2.

Example: DUB width = 90 mm → spacer = 1 mm.

Ti24:

No spacers required if width is between 93–94 mm.

If width <93 mm, spacer = (94 mm – Measured Width) ÷ 2.

Example: Ti24 width = 89 mm → spacer = 2.5 mm (2 mm + 0.5 mm).

5. Install Drive-Side Crankarm

Slide crankarm onto spindle.

Tighten crank bolt to 45 N·m using a 10 mm hex wrench.

Tap crankarm gently with a rubber mallet until fully seated.

Turn preload adjuster clockwise until it stops or contacts the bearing shield.

Tighten locking bolt with a 2 mm hex wrench until the edges touch.

Use opposite hole on preload adjuster with a 2 mm wrench for easier fine tuning.

Do not overtighten the preload adjuster. A small gap is acceptable as long as the top edges are aligned.

6. Check for Play

Rock the crank arms to ensure there's no play.

7. Install Pedals

Grease the pedal threads.

Insert washer between pedal and crankarm.

Tighten to 40 N·m unless otherwise specified.

Note: Left pedal has reverse threads.

Replace Self-Extracting Bolt & Cap

Use OVERFAST-specific tool.

Tighten counterclockwise to 15 N·m. Cap uses reverse threading.

所需工具

扭力扳手

10mm 内六角扳手 / 六角批头

ParkTool BBT-22 中轴锁环工具

游标卡尺

橡胶锤

金属防融合剂或组装润滑脂

1、安装标准盘爪或功率盘爪

盘爪兼容 Easton 标准，适用于 XCADEY、SIGEYI、P2M 等功率盘爪。

使用 ParkTool BBT-22 工具安装锁紧环，锁紧扭矩为 35 - 40N·m。

如为 24Ti 轴心，必须在锁紧前安装专用垫片（仅适用于 24 mm 轴心）。

2、测量 BB 安装后的五通总宽度

使用游标卡尺测量中轴安装后的五通总宽度。

3、安装非驱动侧曲柄

在主轴指定位置涂抹润滑脂。

Ti24 轴心：在螺纹处使用防卡剂，轴心与 BB 接触面涂润滑脂。

DUB 轴心：螺纹与接触面都涂润滑脂，无需防卡剂。

注意：Ti24 与 DUB 轴心都禁止使用界面脂！

插入非驱动侧曲柄与主轴。

4、安装驱动侧垫片

DUB规格：

若宽度为 91 - 92 mm，无需垫片。

若宽度 <91 mm，垫片 = (92 mm - 实测宽度) ÷ 2

例如：DUB 宽度 90 mm → 垫片 = 1 mm

Ti24规格：

若宽度为 93 - 94 mm，无需垫片。

若宽度 <93 mm，垫片 = (94 mm - 实测宽度) ÷ 2

例如：Ti24 宽度 89 mm → 垫片 = 2.5 mm (2mm + 0.5mm)

5、安装驱动侧曲柄

将曲柄滑入主轴。

使用 10 mm 六角扳手将螺丝上紧至 45 N·m。

用橡胶锤轻敲曲柄确保完全就位。

顺时针旋转预紧环，直至其停止或接触轴承防尘盖。

用 2 mm 内六角将预紧螺丝拧紧，边缘贴合即完成。

可将 2 mm 扳手插入预紧环对侧孔位作把手，便于微调。

不要过度旋紧预紧环，以免损伤轴承。留一点缝隙没关系，只要边缘贴合即可。

6、检查间隙

前后轻摇曲柄，确认无松动感。

7、安装脚踏

在踏板螺纹处涂抹润滑脂。

安装垫圈于踏板与曲柄之间。

按照脚踏厂家扭矩标准锁紧，建议为 40 N·m。

注意：非驱动侧（左）为反牙螺纹。

更换自拆卸螺丝及螺丝盖

使用 OVERFAST 专用工具安装。

螺丝采用反牙设计，逆时针拧紧至 15 N·m。

WARRANTY

OVERFAST Warranty Policy

We provide a limited warranty of two (2) years from the date of original purchase, covering non-human damage caused by defects in materials or workmanship.

General Provisions

- This warranty applies only to the original purchaser and is non-transferable.
- Claims under this warranty must be submitted through the original point of sale or an authorized service center, with valid proof of purchase.
- Within the warranty scope, we will repair, replace, or refund the product at our discretion.
- Claims must be made during the warranty period and within one (1) year of the issue arising.

Warranty Exclusions

The warranty does not apply in the following cases:

- Damage due to incorrect installation, adjustment, or lack of maintenance
- Damage from crashes, impacts, abuse, or use beyond intended design
- Damage caused by unauthorized modifications or repair attempts
- Serial number or production code tampering, removal, or defacement
- Damage caused by using incompatible or non-approved components
- Damage resulting from commercial (e.g., rental) use

No Other Warranties

Except as stated above and to the extent permitted by law, we make no other warranties—express or implied—including but not limited to warranties of merchantability, fitness for a particular purpose, or reasonable care.

Limitation of Liability

We are not liable for any direct, indirect, incidental, or consequential damages arising from product use, except where prohibited by law.

Your Legal Rights

This warranty does not affect your statutory rights. If local laws differ, those laws shall take precedence.

本产品提供自原始购买日期起为期两（2）年的有限质保，涵盖因材料或制造工艺缺陷导致的非人为损坏。

一般条款

- 此保修仅适用于原始购买者，且不可转让。
- 所有保修申请必须通过原购买渠道或授权服务点提出，并附上有效购买凭证。
- 本公司将在保修条款范围内，对产品进行维修、更换或退款，具体由我们决定。
- 保修申请必须在保修期内提出，且在相关问题首次出现后的一年内提交。

保修不涵盖

以下情况不属于保修范围：

- 因错误安装、调整、或未按照使用说明维护而导致的损坏
- 因摔车、撞击、滥用、超出设计使用范围所造成的损坏
- 自行拆解、改装或尝试维修所导致的损坏
- 序列号或生产编码被篡改、损毁或移除
- 与本产品不兼容的其他零件使用所造成的损坏
- 商业用途（如租赁）所引起的损坏

除外条款

除非当地法律另有规定，我们不提供除上述条款以外的其他明示或暗示保修，包括但不限于适销性、特定用途适用性或合理照料责任的任何保证。

责任限制

在任何情况下，我们均不对由于产品问题所引发的任何直接、间接、附带或连带损失承担责任（法律禁止的除外）。

法律权利

本保修条款不影响您在所在国家/地区享有的消费者法定权益。若当地法律与本保修条款冲突，以当地法律为准。